

GRAB BAR

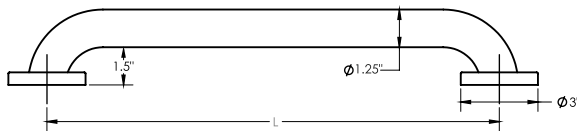

INFORMATION

- Grab bar must be screwed into a wood stud or on wood blocking for proper secured installation. If your walls don't have blocking, add it by nailing a piece of plywood into the studs.
- Grab bars are no stronger than the anchors and walls to which they are attached and, therefore, must be firmly secured in order to support the loads for which they are intended.
- Available Length (L) : 12", 16", 18", 24", 30", 36", 42", 48"



MOUNTING FLANGE

TOOLS AND MATERIALS INCLUDED

Mounting Screws (Qty 8) | Snap-on Cover (Qty 2) | Grab Bar (Qty 1)

TOOLS NEEDED FOR INSTALLATION (Not Included)

Phillips Head Screwdriver | Drill | Level | Tape Measurer | Hammer

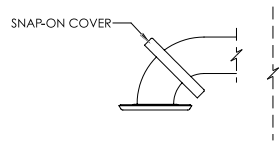
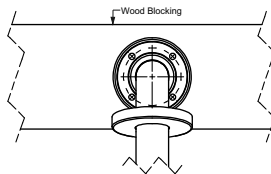
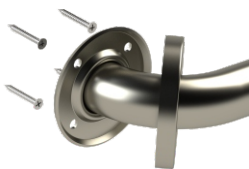

INSTALLATION INSTRUCTIONS:

1. Using a level determine the location of the grab bar.
2. Using the mounting flanges as a template, use a pencil to lightly mark desired screw placement. Repeat for other side.
3. Drill holes at each fastener location using the drill size for the appropriate fastener.
4. Using the appropriate fasteners, screw the grab bar onto the wooden block.
5. Snap or twist the flange covers over the mounting flanges.